

# Wide-i SeaCam®

A Low-Light Camera with a Wide Field of View.



## FEATURES

**Low-Light Black & White and Low-Light Color**

**Wide Angle with CCD Reliability**

**125 (H) x 89 (V) Degree Angle of View Under Water**

**Automatic Backlight Compensation**

**Depth Rated to 6000 meters**

T: (858) 576-1261  
F: (858) 576-0219

4033 Ruffin Road  
San Diego, CA  
92123- 1817 USA

[www.deepsea.com](http://www.deepsea.com)  
[sales@deepsea.com](mailto:sales@deepsea.com)



# Wide-i SeaCam®

Mechanical Specifications		
Housing	Hard Anodized 6013 Aluminum	
Port	Optically Polished Glass	
Outer Diameter	58.4 mm (2.30 in)	
Overall Length (w/o connector)	107.7 mm (4.24 in)	
Weight in Air	0.542 kg (1.196 lbs.)	
Weight in Water	0.29 kg (0.639 lbs.)	
Environmental Specifications		
Depth Rating	6000 m (20,000 ft)	
Operating Temperature	-10° C to 40° C (-14° F to 104° F)	
Storage Temperature	-30° C to 70° C (-22° F - 158° F)	
Optical Specifications		
Focus	Fixed Focus	
Depth of Field	Air: 38 mm (1.5 in) to infinity Water: 25 mm (1.0 in.) to infinity	
FOV in Air	160° (H) x 146° (V)	
FOV in Water	125° (H) x 89° (V)	
Video Specifications		
	B/W	Color
Image Sensor	1/3 inch CCD Sensor	1/3 inch CCD Sensor
Number of Pixels	EIA: 811 (H) x 508 (V) CCIR: 795 (H) x 596 (V)	NTSC: 811 (H) x 508 (V) PAL: 795 (H) x 596 (V)
Resolution	570TVL (center)	450 TVL (center)
Scene Illumination	0.002 Lux F1.4	0.1 Lux F1.2
Signal to Noise	46 dB	More than 50 dB
Video Output	Composite, 1.0 Vp-p 75 ohm, unbalanced	
Video Format	EIA or CCIR	NTSC or PAL
Electrical Specifications		
Power	11-30 V DC	
Current	160 mA	145 mA

## Standard Connector MCBH4MP



- 1 = Ground
- 2 = Power
- 3 = Video
- 4 = Not Used

\*Other connectors and pin-out options are available upon request.

## Dimensions

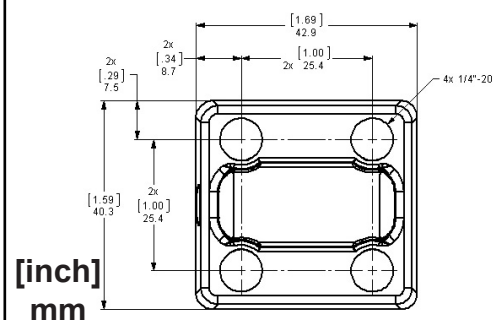
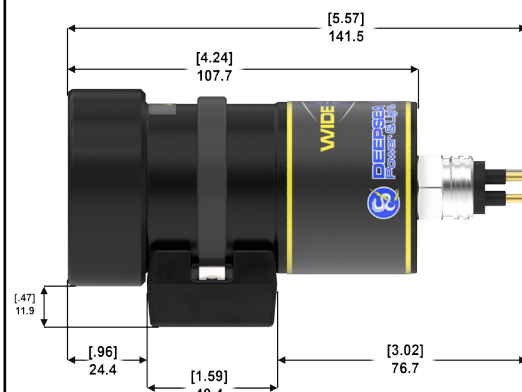

T: (858) 576-1261  
F: (858) 576-0219

4033 Ruffin Road  
San Diego, CA  
92123-1817 USA

www.deepsea.com  
sales@deepsea.com

